

## Draw Wire Potentiometer



- Potentiometric, voltage divider
- Easy mounting
- High protection degree

### Main Applications

Offers easy mounting and quick solution for linear transducers

Hydraulic presses

Cranes

Wood working, profile and metal processing machinery

General automation applications

### Specifications

Measurement type	Resistive
Linearity	0,5%, 0,1% or 0,05%
Measurement stroke	800mm, 1800mm
Output signal type	Voltage divider
Output type	Voltage, 4-20 mA, 0-20 mA or 0-10 V
Supply voltage	24V DC max(for voltage output) and 13-30V
Electrical connection	2.5 meter cable (standard)
Working temperature	-20°C ... +80°C
Case material	Plastic, stainless steel
Protection degree	IP 64

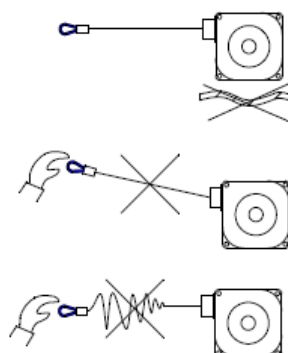
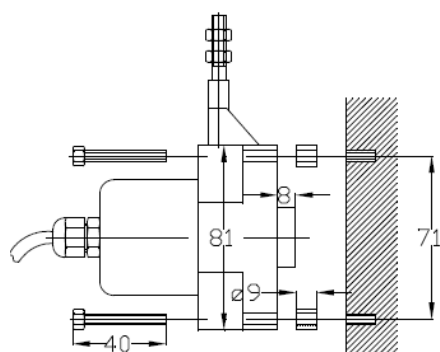
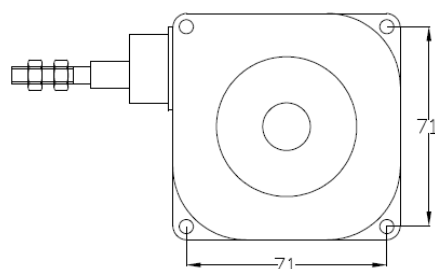

### CAUTION

Do not draw the string maximum than measurement stroke

### Ordering Procedure

DWP	1800	B	5K	2.5 m
Model	Measurement Stroke	Linearity	Output	Cable length
DWP	800mm 1800mm	B= 0,5% C= 0,1% D= 0,05%	5K: 5 KΩ 10K: 10 KΩ V10: 0-10V I4: 4-20mA I20: 0-20mA	2m5: 2.5 meter 5m: 5 meter 7m: 7 meter 8m: 8 meter 10m: 10 meter